

Madison, Wisconsin

CITY OF MADISON

CITY ENGINEERING DIVISION

DEPARTMENT OF PUBLIC WORKS

PLAN OF PROPOSED IMPROVEMENT

STREETS EAST STORMWATER IMPROVEMENT

CITY PROJECT NO. 11122
CONTRACT NO. 7557

PUBLIC IMPROVEMENT PROJECT APPROVED

JULY 7, 2015

BY THE COMMON COUNCIL OF MADISON, WISCONSIN

PUBLIC IMPROVEMENT DESIGN APPROVED BY:



 7/27/15
City Engineer Date

PROJECT DESIGNED BY



INDEX OF SHEETS

SHEET NO.	TITLE
1	OVERALL PLAN
2	WEST ALIGNMENT
3	EAST ALIGNMENT
4	SCREEN STRUCTURE 1 (S-1)
5	SCREEN STRUCTURE 2 (S-7)
6	STORM SCHEDULE
7	

CONVENTIONAL SIGNS	
FIELD VERIFY ALL UTILITY LOCATIONS	
GAS	— G —
STORM SEWER	— ST —
SANITARY SEWER	— SAN —
WATER	— W —
OVERHEAD ELECTRIC	— OH —
POWER POLE	
HANDICAP RAMP	
COMBUSTIBLE FLUIDS	

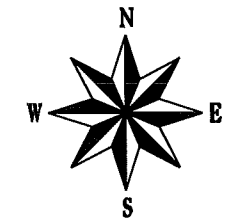
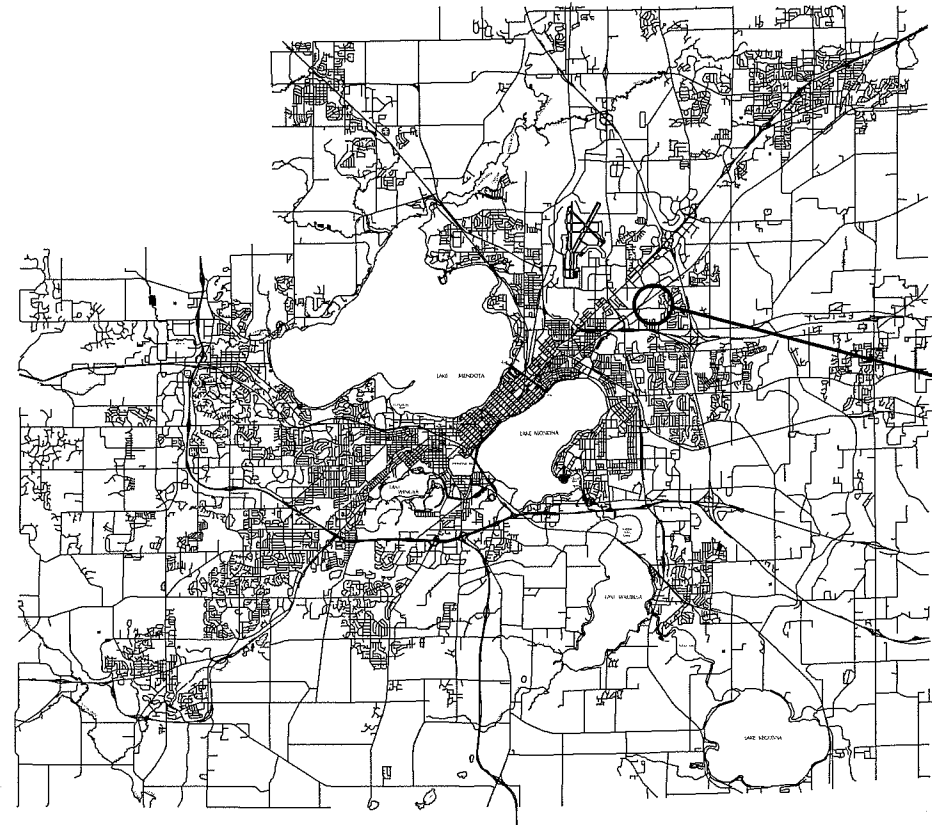

PROJECT LOCATION

PLANNED EARTHWORK QUANTITIES
EXCAVATION CUT (MEASURED PLAN QUANTITY).....175 CY

PLOT SCALE:

PLOT NAME:

REV. DATE:

ORIGINATOR: CITY OF MADISON, STREETS DIVISION

0810-342-0239-1
 CITY OF MADISON ENGINEER
 4452 SYCAMORE AVE

0810-342-0240-8
 EAST SIDE PUBLIC WORKS
 CITY OF MADISON STREETS
 4502 SYCAMORE AVE
 STORAGE BUILDING

0810-342-0240-8
 EAST SIDE PUBLIC WORKS
 CITY OF MADISON STREETS
 4502 SYCAMORE AVE

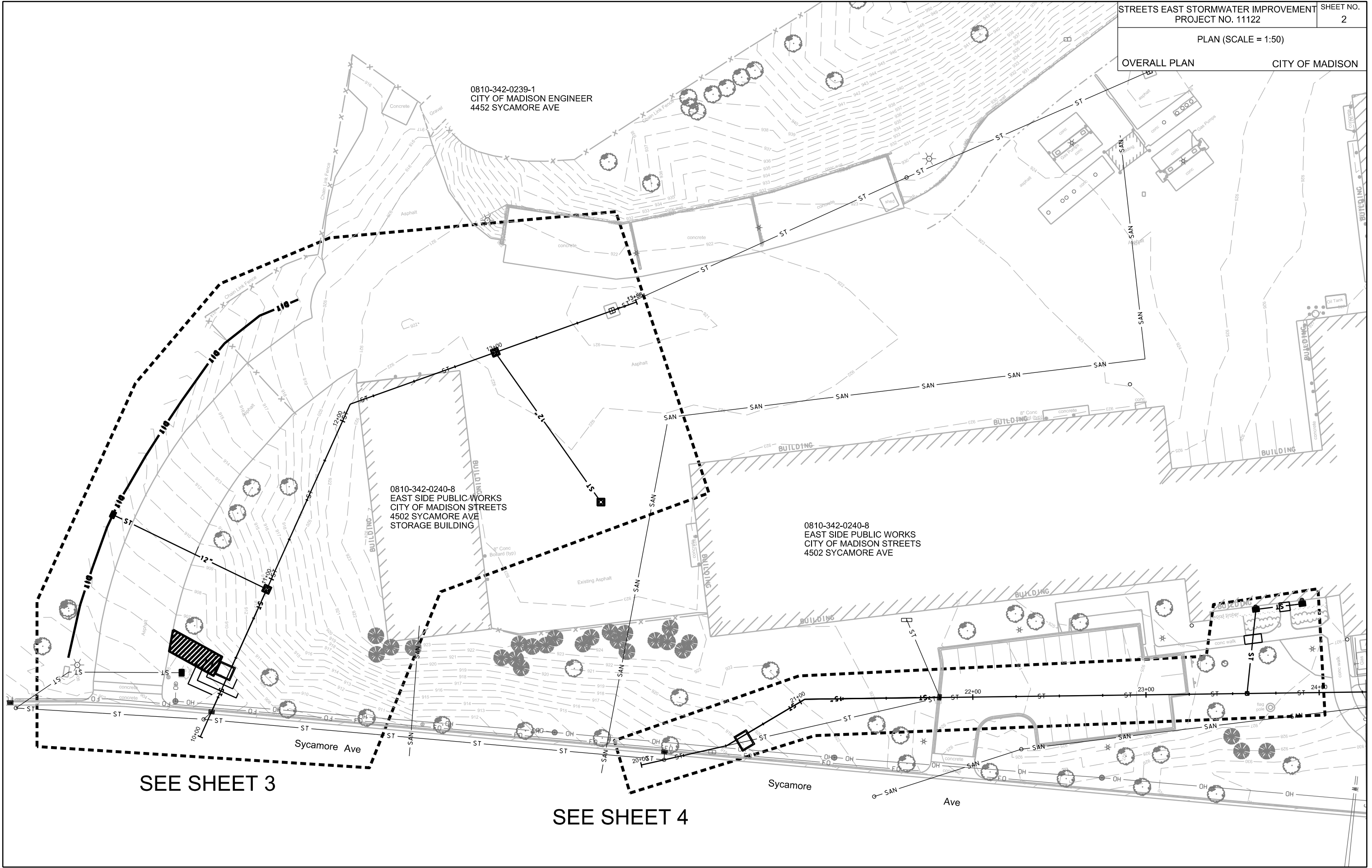

SEE SHEET 3

SEE SHEET 4

PLOT SCALE: _____

REV. DATE: _____

ORIGINATOR: CITY OF MADISON, STREETS DIVISION

0810-342-0240-8
EAST SIDE PUBLIC WORKS
CITY OF MADISON STREETS
4502 SYCAMORE AVE

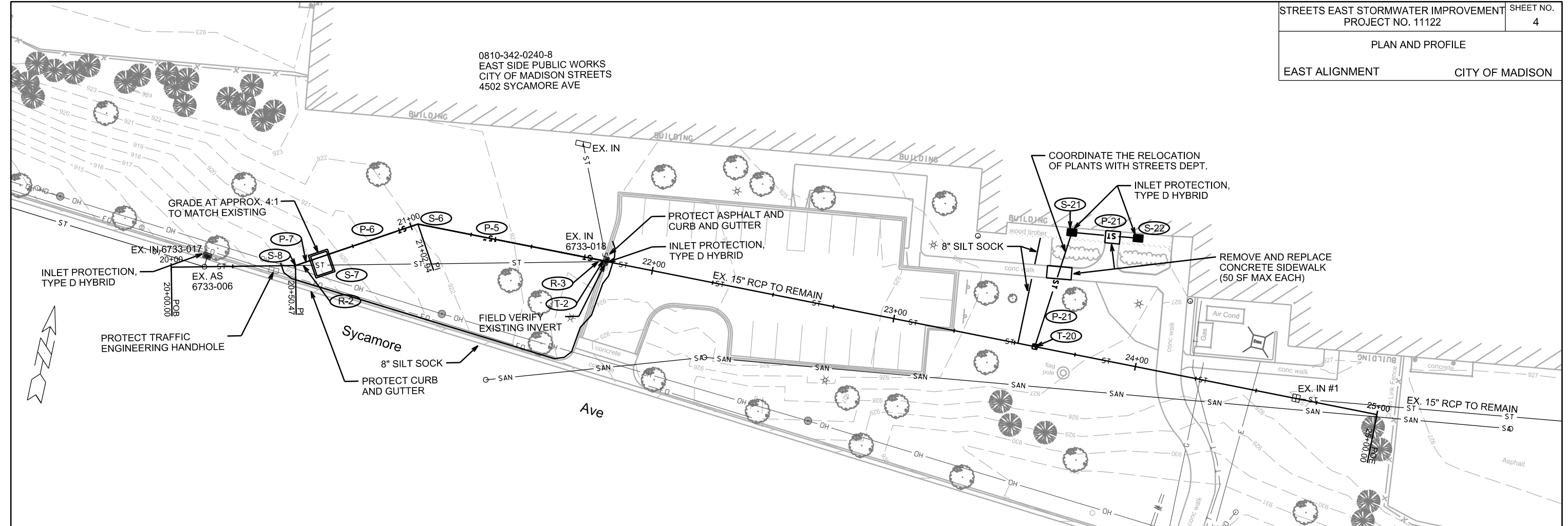

PLOT SCALE: _____

PLOT NAME: _____

REV. DATE: _____

ORIGINATOR: CITY OF MADISON, STREETS DIVISION

STORM SEWER SCHEDULE

PROPOSED STORM STRUCTURES

STRUC NO.	STATION	LOCATION TYPE (OFFSET)	DEPTH	NOTES	TOP OF CASTING	E.I.
S-1	10+40.54	LT-2.67	10.05	SCREEN TREATMENT STRUCTURE 1	907.87	900.82
S-2	10+93.47	LT-0.00	11.06	3'X3' STORM SAS	914.78	903.72
S-3	10+96.25	LT-98.66	2.50	H INLET	907.50	905.00
S-4	12+99.68	RT-0.00	10.01	3'X3' STORM SAS	921.49	911.48
S-5	13+28.04	RT-101.97	3.63	3'X3' STORM SAS W/ SUMP	922.07	918.44
S-6	21+02.94	LT-0.00	-	30 DEGREE BEND	-	916.29
S-7	20+60.82	RT-2.67	9.83	SCREEN TREATMENT STRUCTURE 2	919.41	912.58
S-8	20+50.47	RT-0.00	-	CONCRETE COLLAR	-	912.29
S-9	10+29.33	LT-25.00	2.32	H INLET	904.00	901.68
S-21	23+64.07	LT-48.50	3.13	H INLET	926.93	923.80
S-22	23+90.92	LT-51.42	2.89	H INLET	927.29	924.40

PROPOSED STORM PIPES

PIPE NO.	FROM SAS (DWNSTRM)	TO SAS (UPSTREAM)	EI # (DWNSTRM)	EI # (UPSTRM)	PIPE LENGTH (FT)	PLAN LENGTH (FT)	SLOPE (%)	SIZE (DIA)	TYPE	NOTES	
P-1	EX. IN 6733-003	S-1	900.72	900.82	20	25	0.50%	18"	STORM		
P-2	S-1	S-2	903.32	903.72	48	53	0.83%	18"	STORM		
P-3	S-2	S-3	904.22	905.00	96	99	0.81%	12"	RCP		
P-4	S-4	S-5	917.93	918.44	102	106	0.50%	12"	RCP		
P-5	S-6	EX. IN 6733-018	916.29	918.69	77	78	3.12%	15"	STORM		
P-6	S-7	S-6	915.08	916.29	39	42	3.12%	15"	STORM		
P-7	S-8	S-7	912.29	912.58	7	10	4.21%	15"	STORM		
P-20	T-20	S-21	920.44	923.80	49	48	7.00%	10"	STORM	NOTE 3	
P-21	S-21	S-22	923.80	924.40	27	24	2.50%	10"	STORM	NOTE 3	
						485					

STORM STRUCTURE TAP

STRUC ID NO.	STATION	LOCATION (OFFSET)	TYPE	NOTES
T-1	IN 6733-003	10+15.82	RT-0.01	H INLET
T-2	IN 6733-018	21+81.01	RT-0.00	H INLET
T-20	-	23+58.38	CL	15" VP PIPE

STORM PIPE REMOVAL

PIPE REMOVAL NO.	REMOVE FROM	REMOVE TO	LENGTH (FT)	PAID (Y/N)	SIZE	TYPE	NOTES
R-1	IN 6733-003	STA 10+94.97	RT-0.02	78	N	18"	RCP
R-2	STA 20+50.47	RT-0.00	STA 20+69.48	RT-6.18	20	Y - PLUG	15"
R-3	STA 21+79.90	RT-0.24	STA 21+70.12	RT-2.31	10	Y - PLUG	15"

NOTE: PLAN LENGTH (PAY LENGTH) IS FROM CENTER OF STRUCTURE TO CENTER OF STRUCTURE. PIPE LENGTH IS ACTUAL LENGTH OF PIPE FROM STRUCTURE WALL TO STRUCTURE WALL. SLOPE CALCULATED USING PIPE LENGTH.

SPECIAL NOTES:

- STRUCTURE INCLUDES 3-FOOT SUMP BELOW LISTED INVERT (BID ITEM 90032)
- PLACE SEWER ELECTRONIC MARKER ABOVE STORM SEWER TAP AND BEND LOCATIONS (BID ITEM 50390)
- REMOVE, SALVAGE, AND RESET WOOD TIMBERS LANDSCAPE STONE AS NECESSARY TO INSTALL STORM SEWER PIPE.

STANDARD NOTES:

- ABBREVIATIONS: AE = APRON ENDWALL; RCP = REINFORCED CONCRETE PIPE; HERCP = HORIZONTAL ELLIPTICAL REINFORCED CONCRETE PIPE; DNA = DOES NOT APPLY; SAS = SEWER ACCESS STRUCTURE; LP = LOW POINT INLET STRUCTURE; FP = FIELD POURED STRUCTURE; TR = TOP OF CONCRETE ROOF; NCM = NO CROWN MATCH FOR PIPES; UD = UNDERDRAIN
- APPROXIMATE DISCHARGE E.I. GIVEN, ADJUST E.I. AND PIPE SLOPE IN THE FIELD.
- TOP OF CASTING GRADE GIVEN IS THE TOP OF CURB FOR INLET STRUCTURES AND THE FLOWLINE OF THE CLOSED CASTING FOR SAS's.
- TOP OF CONCRETE ROOF (TR) IS 1.25' BELOW TOP OF CASTING UNLESS OTHERWISE NOTED.
- ALL REINFORCED CONCRETE PIPES TO BE CLASS III UNLESS OTHERWISE NOTED.
- SURVEYOR TO CONFIRM THAT ALL INLET STATION / OFFSETS LINE UP WITH PROPOSED CURB AND GUTTER.
- ALL STRUCTURES CALLED OUT AS FIELD POURED SHALL BE FIELD POURED. ALL OTHER STRUCTURES (NOT INDICATED AS FIELD POURED) SHALL BE SUBMITTED TO CITY ENGINEERING FOR APPROVAL IF PRECAST STRUCTURES ARE PREFERRED. CONTACT LAUREN STRIEGL OF CITY ENGINEERING AT (608) 266-4094, LSTRIEGL@CITYOFMADISON.COM, FOR PRECAST APPROVALS, OR FAX SHOP DRAWINGS TO (608) 264-9275.